

# TIP-ON for doors and stay lifts

Easy opening with integrated door gap adjustment

[www.blum.com](http://www.blum.com)

 **blum**<sup>®</sup>







## **Contents**

- 6** Programme
- 10** Applications for doors
- 12** Applications for stay lifts
- 14** Manufacturing support
- 18** Universal programme
- 20** Ordering and planning information
- 24** Assembly and adjustment
- 26** Blum

# Functional opening comfort

Handle-less fronts are playing an ever increasing role in modern furniture design. Handle-less furniture opens with a gentle push on the front with the TIP-ON mechanical opening support system by Blum. To close, simply press shut. TIP-ON can be combined with the proven unsprung CLIP top hinge to deliver top quality motion for doors. Additionally TIP-ON supports handle-less designs incorporating AVENTOS stay lift systems.

 **blum**



### TIP-ON for doors

When combined with the tried-and-tested unsprung CLIP top hinge, TIP-ON opening support provides functional opening comfort and freedom of motion for doors in base and wall cabinets.



### TIP-ON for stay lifts

The AVENTOS HK series: AVENTOS HK, AVENTOS HK-S and AVENTOS HK-XS are compatible with TIP-ON mechanical support system allowing for freedom of design in wall cabinets. AVENTOS lifts offer an ergonomic wall cabinet solution with easy access to cabinet interiors and unhindered movement.



## New programme

You will always find the right TIP-ON unit for doors and AVENTOS stay lifts thanks to the choice of colours and programme of corresponding adapter plates. You can opt between the short and long version of TIP-ON, for drilling or with an adapter plate depending on the application. The door gap adjustment feature is integrated in all models. The fitting merges beautifully with the cabinet interior, offering freedom of design and top quality motion.

 **blum**





### Tool-free door gap adjustment

The adjustment feature (+4/-1mm) has been integrated into all TIP-ON units for optimal ease. To adjust the gap, simply turn the ejector pin. The click-stop positions allow you to easily find the right setting. For user confidence, the ejector pin cannot be unscrewed.



+4/-1 mm

### Revised adapter plate programme

Both the short and long version of TIP-ON can be combined with a complementary inline adapter plate. The rectangular and straight-cut plate ensures a sleek and discreet look. When combined with the adapter plate, the door gap can be adjusted to a minimum of 1.5mm.



### Harmonious integration

TIP-ON can be integrated beautifully with cabinet interiors. The fitting comes in two colours, Silk white and Terra black, giving you great freedom of design.



# Freedom of design and motion

Handle-less designs in kitchen, living, dining, bedroom and bathroom applications incorporating doors and lifts open and close with ease with TIP-ON. Products which are easy to open support daily workflows ensuring problem free use for the lifetime of the furniture.

blum®



Ideas from Blum  
for practical kitchens

## Blum's ideas for practical kitchens

A kitchen has to be fit for everyday use. That's why Blum has been researching the requirements of kitchen users for years. In this way, new ideas for making modern kitchens even more practical are constantly being generated as part of DYNAMIC SPACE. More information can be found at [www.blum.com](http://www.blum.com)



### Easy opening

A gentle push on the front releases the door or lift system so you can open handle-less furniture with ease. Comfort and freedom of motion is unrestricted thanks to TIP-ON opening doors and lifts at a convenient angle.



### Quiet closing

TIP-ON ensures the closing of furniture is quiet thanks to the housing of the unit; allowing the catch plate to hit the housing when doors and lifts are pushed closed, rather than hitting the magnet itself.



### Secure closing

A latch function secures the door or lift after being gently pushed closed. The TIP-ON magnet ensures the front remains securely closed.



# Applications for doors

The revised TIP-ON programme offers you even more design options for handle-less doors throughout the home. All components harmonise beautifully within cabinet interiors with TIP-ON. No matter whether TIP-ON for drilling or TIP-ON with an adapter plate, the fitting delivers the top quality motion you can rely on.

**blum**



## Standard door applications

TIP-ON can be combined with the 120° and 100° CLIP top unsprung hinges to deliver top quality motion for doors in standard applications.



## Cabinet solution applications

TIP-ON is compatible with the 155° unsprung zero-protrusion hinge. This hinge is ideally suited to support Blum's SPACE TOWER cabinet solution for the pantry; ensuring doors open with a gentle push right out of the way of the inner drawers and pull-outs.



## Special applications

Handle-less designs can be accommodated throughout the home when combining profile door and angled hinges with TIP-ON. TIP-ON is especially practical where access to power is not available such as in bathroom applications.



Optimal opening support is achieved when the TIP-ON unit is attached exactly where the handle would be. This can be either installed by drilling into the cabinet edge or attaching an adapter plate to the inside of the cabinet.



# Applications for stay lifts

AVENTOS HK series stay lift applications are the perfect solution for wall cabinets of small to medium height in high cabinet applications. The stay lift front kicks outwards; requiring minimal or even no space above the cabinet, allowing for a host of design possibilities. More design options can be achieved for handle-less applications thanks to the revised TIP-ON programme. TIP-ON mechanical support makes opening AVENTOS stay lifts easy and convenient. Lift system fronts stop at every desired position to ensure they always remain within easy reach.



## HK Series

AVENTOS HK series applications are all compatible with TIP-ON mechanical opening support.



AVENTOS HK



AVENTOS HK-S



AVENTOS HK-XS



### Stay lift

AVENTOS HK is best suited to wall cabinets of small to medium height in applications throughout all living areas such as the home office.



### Small stay lift

AVENTOS HK-S is the perfect choice for wall cabinets of small height in high cabinet applications such as over the fridge, pantry or oven.



### Compact stay lift

Combining AVENTOS HK-XS with TIP-ON makes handle-less designs in wall cabinets of small height and low internal depths possible such as in bathroom cabinets.





# Manufacturing support

TIP-ON offers you sophisticated technology and easy adjustment with the door gap adjustment feature integrated in the fitting. Special manufacturing templates by Blum are available to facilitate ease of installation and to ensure TIP-ON functions perfectly.

 **blum**





### Easy assembly

The drilling template for TIP-ON helps you drill the horizontal fixing positions of TIP-ON for doors and stay lifts.



### Optimal protection

The fully enclosed TIP-ON housing ensures perfect installation and protects the technology on the inside of the TIP-ON unit.



### Precise transfer of measurements

The mounting position is indicated on the lower part of the adapter plate. Alternatively use the template for precise positioning.



### Versatile assembly

The adapter plates can be fixed with chipboard screws or system screws - the choice is yours.



### Secure closing

The catch plate completes the TIP-ON function. There are two versions: a glue-on version or one that screws to the front. The TIP-ON magnet ensures the front stays securely closed. Blum recommend the use of the screw-on catch plate.



### Integrated door gap adjustment

The arrow markings tell you in which direction to turn the ejector pin. One turn (=4 click-stop positions) adjusts the door gap by 1mm. The ejector pin cannot be turned beyond the pre-defined adjustment range.

# Services for the Manufacturer

Blum would like to make the ordering, assembly and marketing of its products as easy as possible for our customers and partners. A variety of useful online applications as well as special planning and ordering software are available to support your daily activities.



<p><b>Eon systems</b> Our cabinet profile, up to 3 generations later with different Eon styles.</p> <ul style="list-style-type: none"><li>Learn more...</li><li>Configure Eon systems</li></ul>	<p><b>Runoc systems</b> Our compact drawer systems for smaller kitchen profiles provide flexibility and maximum storage space.</p> <ul style="list-style-type: none"><li>Learn more...</li><li>Configure Runoc systems</li></ul>	<p><b>DINGO 4.0 Eon sliding system</b> The positive new sliding system for a cabinet that is smart and practical.</p> <ul style="list-style-type: none"><li>Learn more...</li><li>Configure DINGO 4.0</li></ul>
<p><b>Hinge systems</b> Hinge connect the cabinet door to the cabinet. There can be applied to different angles and distances depending on the hinge type.</p> <ul style="list-style-type: none"><li>Learn more...</li><li>Configure Hinge systems</li></ul>	<p><b>LM systems</b> LM systems enable you to fit systems providing additional storage in the corner of your kitchen.</p> <ul style="list-style-type: none"><li>Learn more...</li><li>Configure LM systems</li></ul>	<p><b>SOFIO-ORBIT</b> The new orbit SOFIO-ORBIT is available in up to 100°/120°/150° and with 2/3/4-hole design.</p> <ul style="list-style-type: none"><li>Learn more...</li><li>Configure SOFIO-ORBIT</li></ul>

© 2014 Blum GmbH, KEMNATZ

1/2014

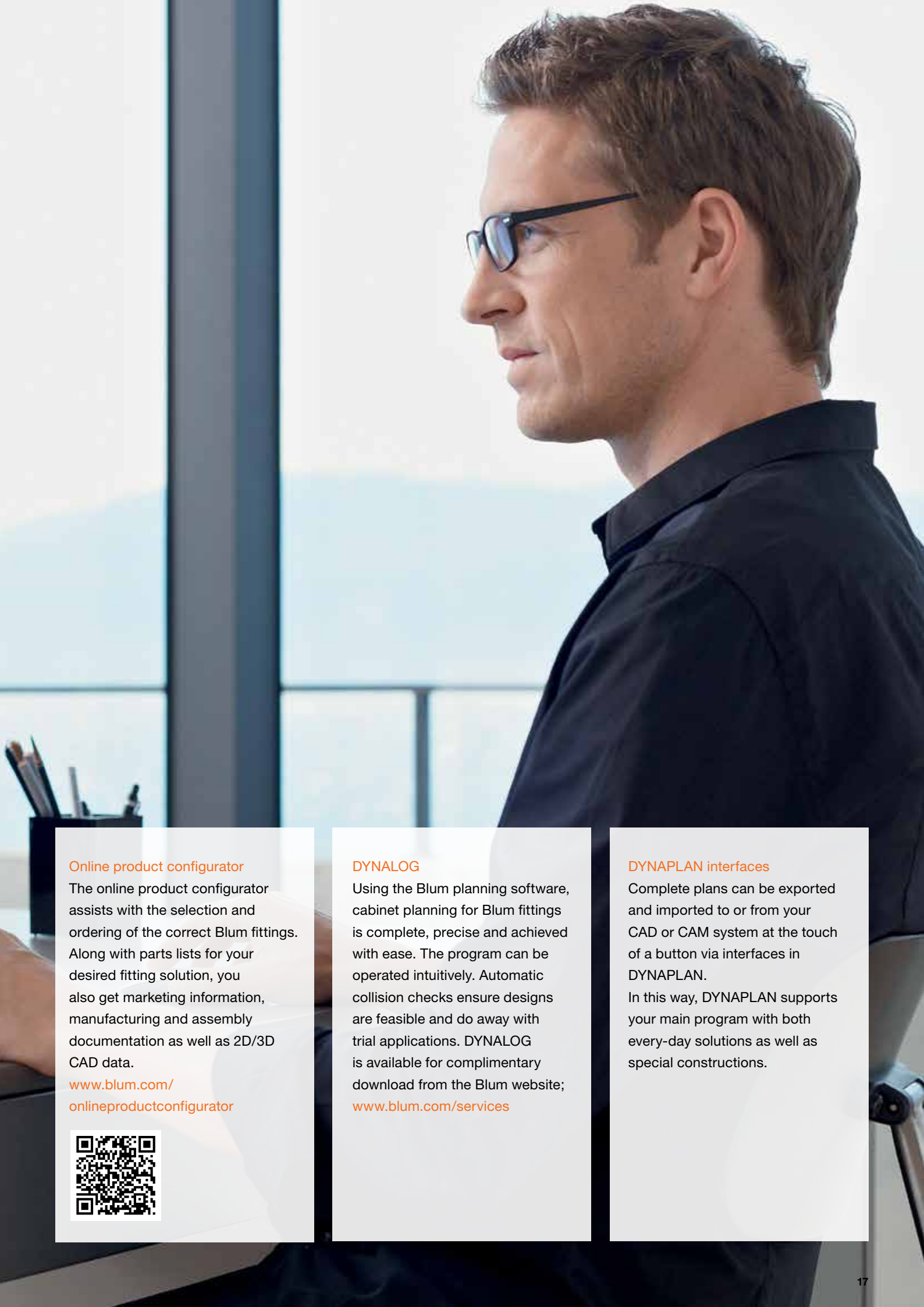

#### Online product configurator

The online product configurator assists with the selection and ordering of the correct Blum fittings. Along with parts lists for your desired fitting solution, you also get marketing information, manufacturing and assembly documentation as well as 2D/3D CAD data.

[www.blum.com/  
onlineproductconfigurator](http://www.blum.com/onlineproductconfigurator)



#### DYNALOG

Using the Blum planning software, cabinet planning for Blum fittings is complete, precise and achieved with ease. The program can be operated intuitively. Automatic collision checks ensure designs are feasible and do away with trial applications. DYNALOG is available for complimentary download from the Blum website;

[www.blum.com/services](http://www.blum.com/services)

#### DYNAPLAN interfaces

Complete plans can be exported and imported to or from your CAD or CAM system at the touch of a button via interfaces in DYNAPLAN.

In this way, DYNAPLAN supports your main program with both every-day solutions as well as special constructions.



# Universal programme

The TIP-ON programme integrates beautifully within cabinet interiors, offering freedom of design and top quality motion to doors and stay lifts. Units are available in both short (standard) and long versions to suit every application. All units, along with their complementing inline adapter plates, are available in Silk white and Terra black. TIP-ON is quick and easy to install either by drilling into the cabinet edge or by attaching an adapter plate to the inside of the cabinet.



## TIP-ON unit



Short version

Long version

## In-line adapter plate



Short version

Long version

## Colour variant



Silk white



Terra black



> Fittings selection made easy with the online product configurator at [www.blum.com/productconfigurator](http://www.blum.com/productconfigurator)

### Note

TIP-ON is not compatible with BLUMOTION soft-close. When planning with or using TIP-ON for doors and stay lifts remember to select unsprung CLIP top hinges and/or AVENTOS stay lift mechanisms without integrated soft-close.









## Unsprung hinges and stay lift mechanisms for TIP-ON applications

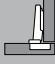

TIP-ON for doors and stay lifts

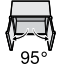

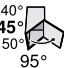
### Door applications

Unsprung CLIP top hinges				
	Application	Boss fixing	Overlay application	Angled
	120° hinge	INSERTA	70T5590BTL	
		Screw-on	70T5550.TL	
	100° hinge	Knock-in	70M2580.TL	
	155° wide angle hinge	INSERTA	70T7540NT1	
		Screw-on	70T7500NTL	
	95° profile door hinge	INSERTA	70T9550.TL	
		Screw-on	70T9550.TL	
	120° aluminium frame door hinge	Screw-on	72T550A.TL	
	Angled hinge +45°l	Screw-on		78A9658.T

### Stay lift applications

AVENTOS Lift mechanisms				
	Application	Power Factor	Opening Angle	
	Aventos HK	480-1500	107°	20K2300T
		750-2500	107°	20K2500T
		1500-4900	107°	20K2700T
		3200-9000	100°	20K2900T
	Aventos HK-S	220-500	107°	20K2B00T
		400-1000	107°	20K2C00T
		960-2215	107°	20K2E00T
	Aventos HK-XS	180-800	105°	20K1101T
		500-1200	105°	20K1301T
		800-1600	105°	20K1501T

#### Note

For full technical and order specification information refer to the AVENTOS brochure or Blum trade catalogue.

## TIP-ON for doors and stay lifts



## Ordering information

### Product



### Order specification

#### Short version with magnet

	Colour variants	
	SW	TS
	956.1004	
<p>For overlay doors up to approx. 1300mm in height. For unsprung hinges Rec. for AVENTOS HK-XS. For drilling Ø10x50mm. Short version, length 50mm incl. 1 x glue-on and 1 x screw-on catch plates.</p>		

#### Long version with magnet

	Colour variants	
	SW	TS
	956A1004	
<p>For overlay doors starting from approx. 1300mm in height. For unsprung hinges. For drilling Ø10x76mm. Long version, length 76mm incl. 1 x glue-on and 1 x screw-on catch plates.</p>		

#### Inline adapter plate – short version – 20/17

	Colour variants	
	SW	TS
	956.1201	
<p>Assembly using chipboard screws Ø3.5mm or Ø4mm or with system screws. For use in combination with TIP-ON short version.</p>		

#### Inline adapter plate – long version – 20/32

	Colour variants	
	SW	TS
	956A1201	
<p>Assembly using chipboard screws Ø3.5mm or Ø4mm or with system screws. For use in combination with TIP-ON long version.</p>		

#### Colour variant abbreviations

SW silk white

TS terra black

Planning

**Short version for drilling**

\* min. 2.6 mm with glue-on catch plate  
\* min. 3.1 mm with screw-on catch plate

**Short version adapter plate**

**Long version for drilling**

\* min. 2.6 mm with glue-on catch plate  
\* min. 3.1 mm with screw-on catch plate

**Long version adapter plate**

**Screw-on/Glue-on catch plate for drilling**

\* For screw-on catch plates we recommend offsetting the positioning of TIP-ON by 3mm. For hard surfaces Ø 2.5 mm pre-drilling and countersinking if required.

The surface of the front must be clean, oil-free and dry

FA front overlay

**Screw-on/Glue-on catch plate with adapter plate**

\* For screw-on catch plates we recommend offsetting the positioning of TIP-ON by 3mm. For hard surfaces Ø 2.5 mm pre-drilling and countersinking if required.

The surface of the front must be clean, oil-free and dry

FA front overlay

**Note**  
Blum recommend the use of the screw-on catch plate for optimal performance.

# TIP-ON for stay lifts



# Planning information

## Planning

**Short version for drilling**

\* min. 3.1 mm with screw-on catch plate

**Short version adapter plate**

**Long version for drilling**

\* min. 3.1 mm with screw-on catch plate

**Long version adapter plate**

**Screw-on catch plate for drilling**

\* For screw-on catch plates we recommend offsetting the positioning of TIP-ON by 3mm. For hard surfaces  $\varnothing$  2.5 mm pre-drilling and counter-sinking if required.

FAu Lower front overlay

**Screw-on catch plate with adapter plate**

\* For screw-on catch plates we recommend offsetting the positioning of TIP-ON by 3mm. For hard surfaces  $\varnothing$  2.5 mm pre-drilling and counter-sinking if required.

FAu Lower front overlay

**Note**

All TIP-ON units are supplied with both screw-on and glue-on catch plates. The glue-on catch plate should not be used in combination with TIP-ON for AVENTOS stay lifts.

Drilling template



Drilling template for BLUMOTION/TIP-ON	
Template for drilling the front face fixing positions for TIP-ON for doors and stay lifts as well as for BLUMOTION for doors handle side and hinge side.	<b>65.5010</b>
Ensures ease of assembly on a marking line.	
Suitable for CLIP top hinges and AVENTOS stay lifts.	
Components	
1 x drilling template for BLUMOTION/TIP-ON, 1 x drilling depth spacer (ø 10mm)	

Drilling template (adapter plate)



Template	
Template for drilling the fixing positions for mounting plates (ø 2.5mm).	<b>65.5300</b>
Facilitates pre-drilling of the fixing positions for adapter plates (BLUMOTION/TIP-ON for doors and stay lifts).	
Ensures ease of assembly on a marking line.	
Suitable for CLIP top hinges and AVENTOS stay lifts.	



## TIP-ON for doors



## Assembly and adjustment

### Assembly

#### Assembly position

Optimal opening support is achieved if the TIP-ON unit is attached exactly where the handle would be.

The fixing position can deviate  $\pm 300$  mm in height and up to a quarter of the cabinet width in terms of width.

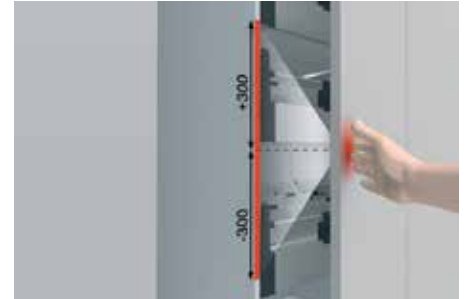

#### Short/long version for drilling

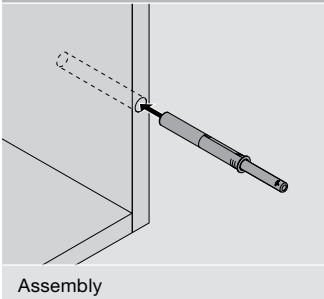

Assembly

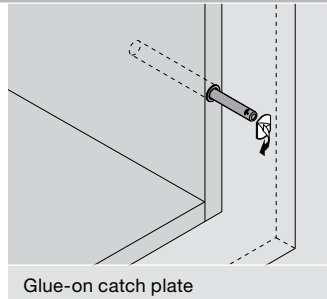

Glue-on catch plate

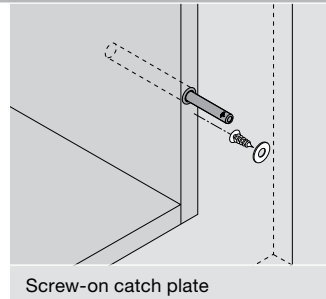

Screw-on catch plate

#### Inline adapter plates

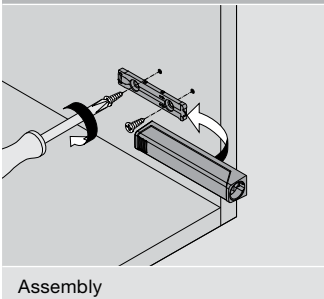

Assembly

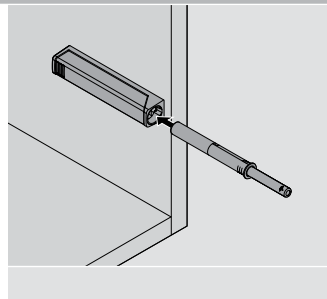

Glue-on catch plate

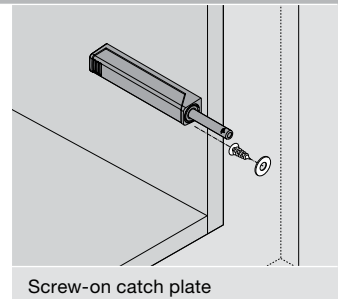

Screw-on catch plate

### Adjustment

#### TIP-ON adjustment

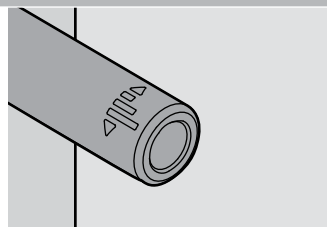
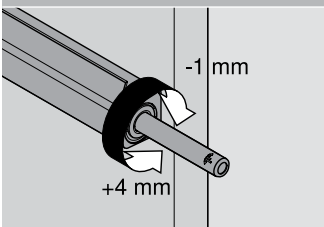

## Assembly

### Assembly position

Optimal opening support is achieved if the TIP-ON unit is attached exactly where the handle would be.

TIP-ON assembly for AVENTOS stay lifts is carried out in the centre of the cabinet bottom panel.

### Short/long version for drilling

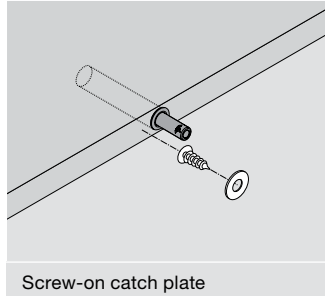
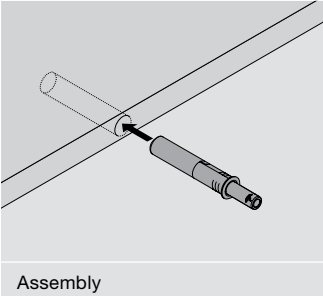

### Inline adapter plates

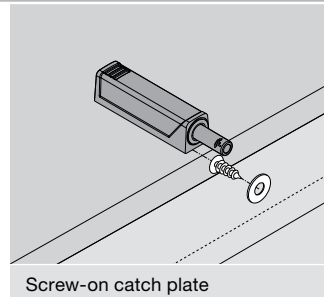
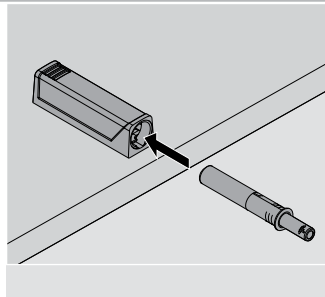
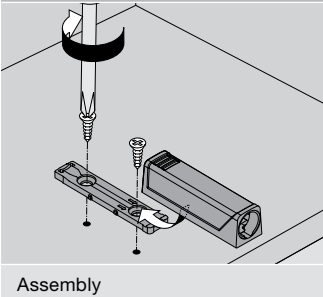

## Adjustment

### TIP-ON adjustment

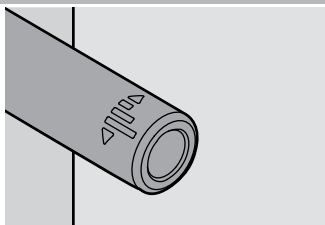
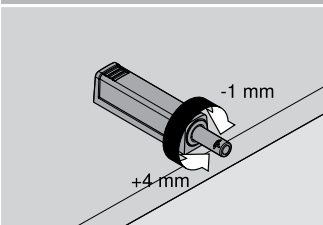

# Blum

Founded over 60 years ago by Julius Blum, today Blum is an internationally active family-owned company. Blum is trusted and renowned worldwide for designing a comprehensive range of high quality industry leading products that significantly enhance user convenience and ergonomics in the kitchen and throughout the home. That's why we make every effort to perfect the motion of our lift, hinge, box and runner systems.





### Design is more than an attractive appearance

Form, function and the focus on perfecting motion are and have always been firmly interlinked at Blum. This means that Blum products turn the use of high-quality furniture into a true experience and offer the ideal fitting solution for every home. Blum incorporates current design trends, personal preferences and functional furniture use. Blum fittings are internationally recognised for their sophisticated design and functional excellence.



### Quality for the lifetime of the furniture

For over 60 years, quality has been the highest principle for the development and manufacture of Blum products. Our fittings exemplify quality with their well-thought-out function and durability, engineered to provide problem free use for the lifetime of the furniture. We achieve this by using the strictest internal guidelines and rigorous testing that form the basis of our ISO9001 Quality Management System.



### Innovation for high living comfort

We want our fitting solutions to be innovative and make everyday kitchen use easier. That's why our developments are based on findings from requirements research and input from our customers. Blum is one of the largest patent applicants in Austria and has more than 1,000 registered trademarks. CLIP, tool free assembly, TANDEM technology, MOVENTO technology, soft-close BLUMOTION and SERVO-DRIVE electrical motion support system are all innovations by Blum and milestones in the furniture manufacturing industry.



### Our contribution to the environment

Blum strives to minimise its environmental impact with environmental protection being an integral part of everything we do. We use environmentally friendly processes, use raw materials intelligently and save energy wherever we can. Our commitment to environmental protection is internationally recognised and rewarded. We endeavour to maintain and are always looking to improve our environmental management systems.





**ISO 50001**  
Certified Energy  
System



**ISO 9001**  
Certified Quality  
System



**ISO 14001**  
Certified Environmental  
System

**Blum Showrooms  
Sydney (Head Office)**

10 Blackbird Close  
Len Waters Estate NSW 2170  
Ph: 02 9612 5400

**Adelaide**

179 Railway Terrace  
Mile End SA 5031  
Ph: 08 8118 6070

**Brisbane**

6/39-45 Compton Road  
Underwood QLD 4119  
Ph: 07 3135 9490

**Melbourne**

245 Ferntree Gully Road  
Mount Waverley VIC 3149  
Ph: 03 9982 1720

**Perth**

3/50 Howe Sreet  
Osborne Park WA 6916  
Ph: 08 6467 0110

Place distributor or company contact details here.

**Blum Australia Pty. Ltd.**  
P.O. Box 1615  
Green Valley NSW 2168  
Toll Free: 1800 179 186  
E-Mail: [info.au@blum.com](mailto:info.au@blum.com)

 **blum**<sup>®</sup>